

Soils Map

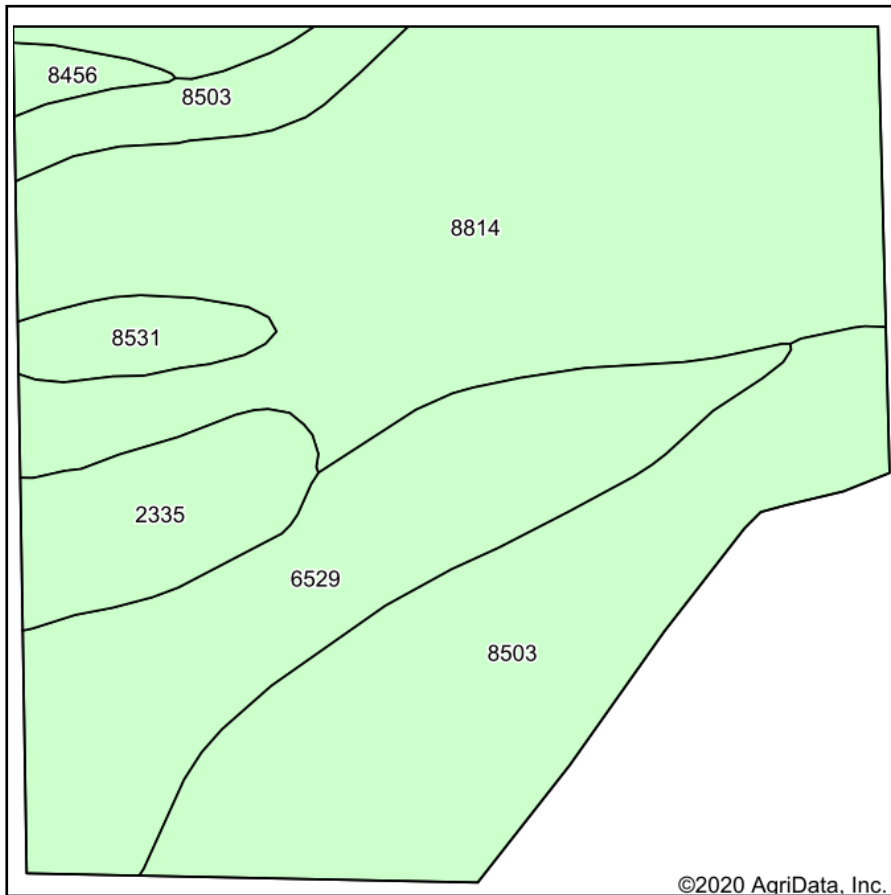

Soils data provided by USDA and NRCS.

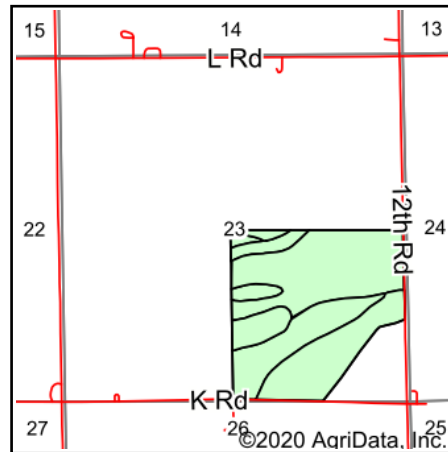

State: **Nebraska**
 County: **Merrick**
 Location: **23-13N-7W**
 Township: **Lone Tree**
 Acres: **138.17**
 Date: **10/16/2020**



Maps Provided By:



© AgriData, Inc. 2020

www.AgriDataInc.com



Area Symbol: NE121. Soil Area Version: 20															
Code	Soil Description	Acres	Percent of field	Non-Irr Class *c	Irr Class *c	SRPG	Alfalfa hay	Alfalfa hay irrigated	Corn	Corn irrigated	Grain sorghum	Grain sorghum irrigated	Soybeans irrigated	Winter wheat	*n NCCPI Soybeans
8814	Cozad loam, wet substratum, 0 to 1 percent slopes	59.67	43.2%	Iw	I	78	5	6	71	158	65	114		38	70
8503	Lex loam, occasionally flooded	37.99	27.5%	IIIw	IIIw	38	3	6	64	148	74	114	39	32	26
6529	Janude sandy loam, very rarely flooded	26.50	19.2%	Ile	Ile	66	3	6	75	154	75	120	42	33	55
2335	Inavale loamy fine sand, 0 to 3 percent slopes	8.91	6.4%	IVe	IIIe	35	1	4		99	30	90		19	28
8531	Novina sandy loam, rarely flooded	3.68	2.7%	IIw	IIw	65	3	6	59	148	64	114	38	30	60
8456	Fonner sandy loam, rarely flooded	1.42	1.0%	IIIw	IIIw	36	2	5	40	131	40	114	36	27	27
Weighted Average						61.1	3.7	5.9	64.6	150.1	66.9	113.6	20.2	33.8	*n 51.6

*n: The aggregation method is "Weighted Average using all components"

*c: Using Capabilities Class Dominant Condition Aggregation Method

Soils data provided by USDA and NRCS.